



WHITE BACK CAN

Q-HY-BC1W

DESCRIPTION:

The Q-HY-BC1W Back Can (suspension) is a metal case that can be attached to a flush-mount ceiling speaker when mounted in exposed applications. Ideal for TOA's F-122C, F-2322C, F-2352C or F-2352SC. The Back Can could also be used in exposed ceiling and can be hung from a ceiling suspension pipe.

SPECIFICATIONS:

Finish	Surface-treated steel plate, t0.8, white paint
Weight	1.5 kg
Accessory	Rubber grommet x 2

APPEARANCE:

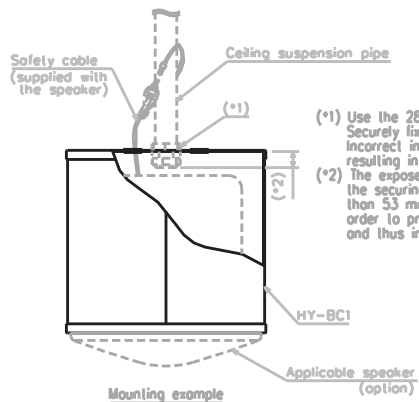
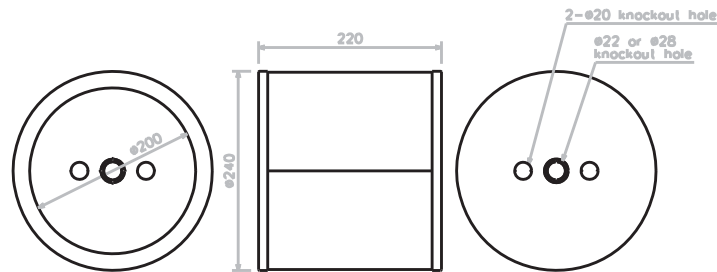

- (*1) Use the 28 mm hole for the suspension pipe mounting. Securely fix to a pipe or fittings. Incorrect installation may cause the joint part to break, resulting in the fall of the Back Can.
- (*2) The exposed length of the suspension pipe on which the securing nut will be tightened must be no longer than 53 mm (26 mm when the F-122CU is used) in order to prevent the bolt from contacting the speaker and thus interfering with correct installation.